

## Installation

TuneECU must be downloaded from the [TuneECU](#) web site.

If you have an earlier version installed, uninstall it from your device (in Settings/Apps) and delete the users.lic file (if exists) in the TuneECU folder.

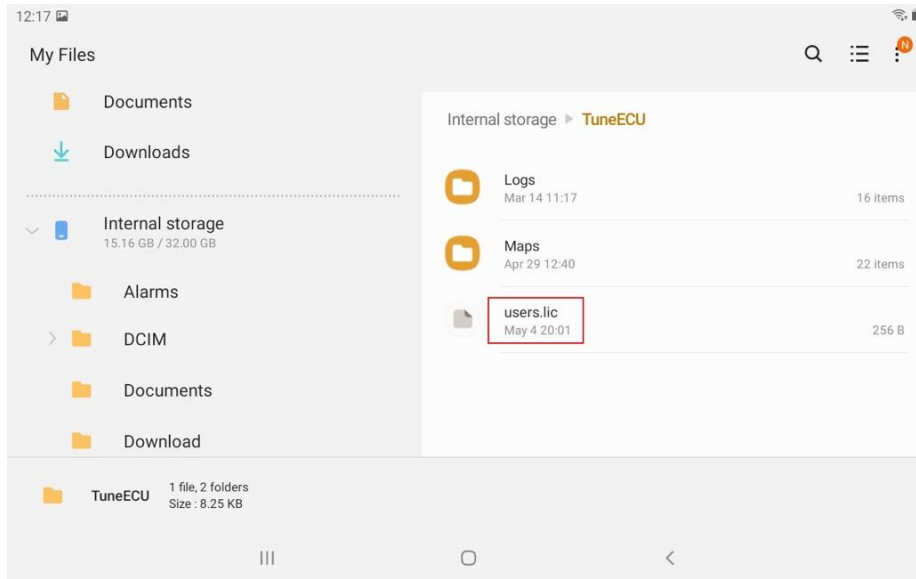

Install and open the app, read and accept the License Agreement, read and allow the Privacy Policy. Allow TuneECU to access to all files on your device.

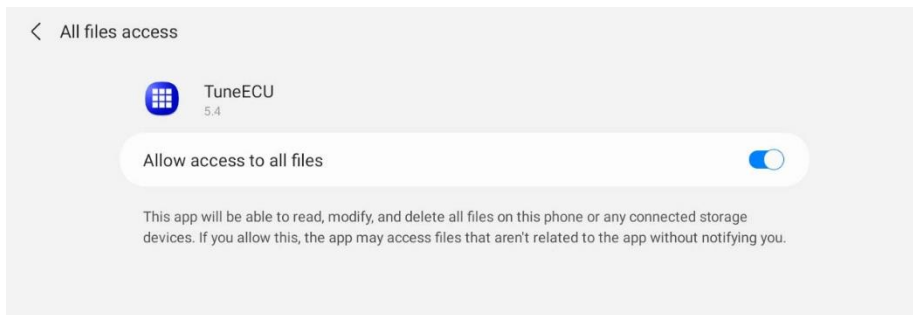

Choose your account (the account you use on your Android device)

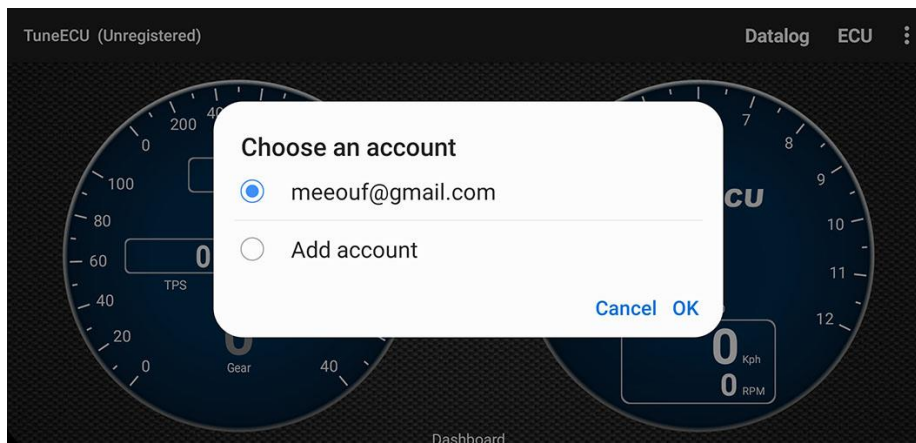

If your license does not already exist on the TuneECU server you must register the app.

To register, go in the menu "3 dots/Help/<version of the app>" click on the button "How to register" and follow the instructions.

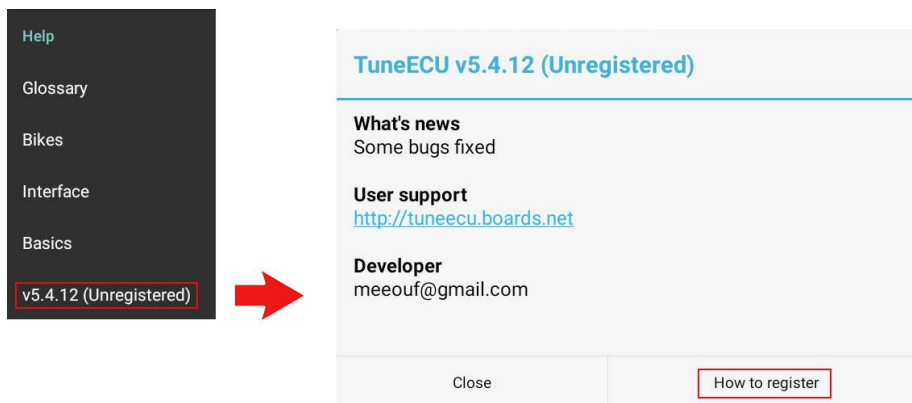

**The standard license allows you to register up to 5 bikes.**

The app ask you a confirmation to register, otherwise you can register the bike later in the menu "ECU/Informations" when connected.

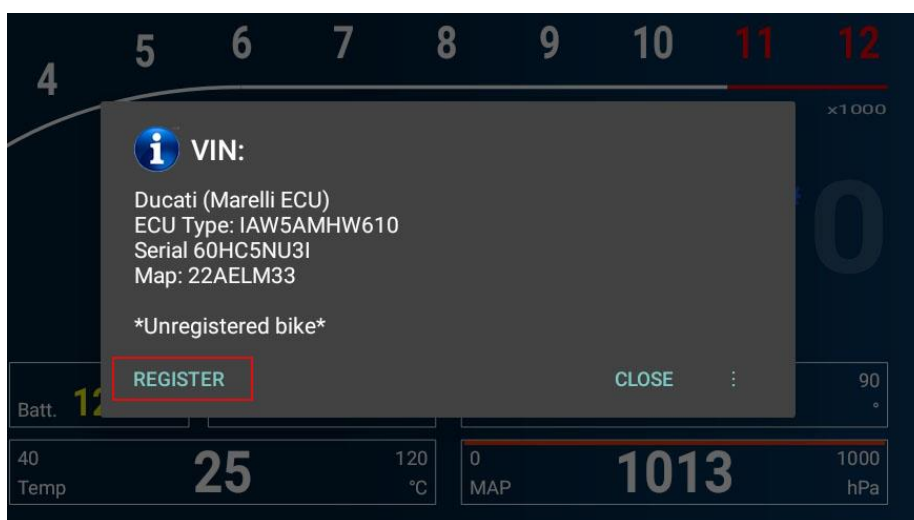

**To manage an unlimited amount of bikes (for professionals) you must buy the Pro license.**

To buy the Pro license (you must have at least one bike registered), go in the menu "3 dots/Help/<version of the app>" click on the button "Buy Pro license" and follow the instructions.